

# Accessories

## Mounting accessories

### Spring washer for motor's fan guard



#### Features

- Quick, secure and easy mounting
- To be mounted on the motor's fan cover

#### Description

Fix spring coupling onto flange by help of the attached screws. Push encoder onto the drive shaft and mount spring coupling onto the contact surface.

#### Part number

11034106 Spring coupling for motor's fan guard  
(Z 119.053)

#### Scope of delivery

Included: spring coupling, two screws M3 x 6

#### Suitable for

G0A2H, G0AMH, G0M2H, G0MMH, G0P5H, GBA2H,  
GBA2S, GBAMH, GBAMS, GBM2H, GBM2S, GBMMH,  
GBMMS, GBP5H, GBP5S, GEMMH, GXA2S, GXAMS,  
GXM2S, GXM7S, GXMMS, GXP5S

#### Dimensions

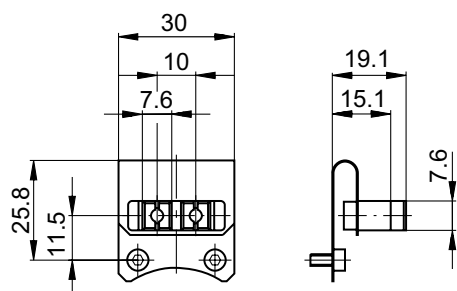

#### Assembly drawing

